

FORM No. 1.

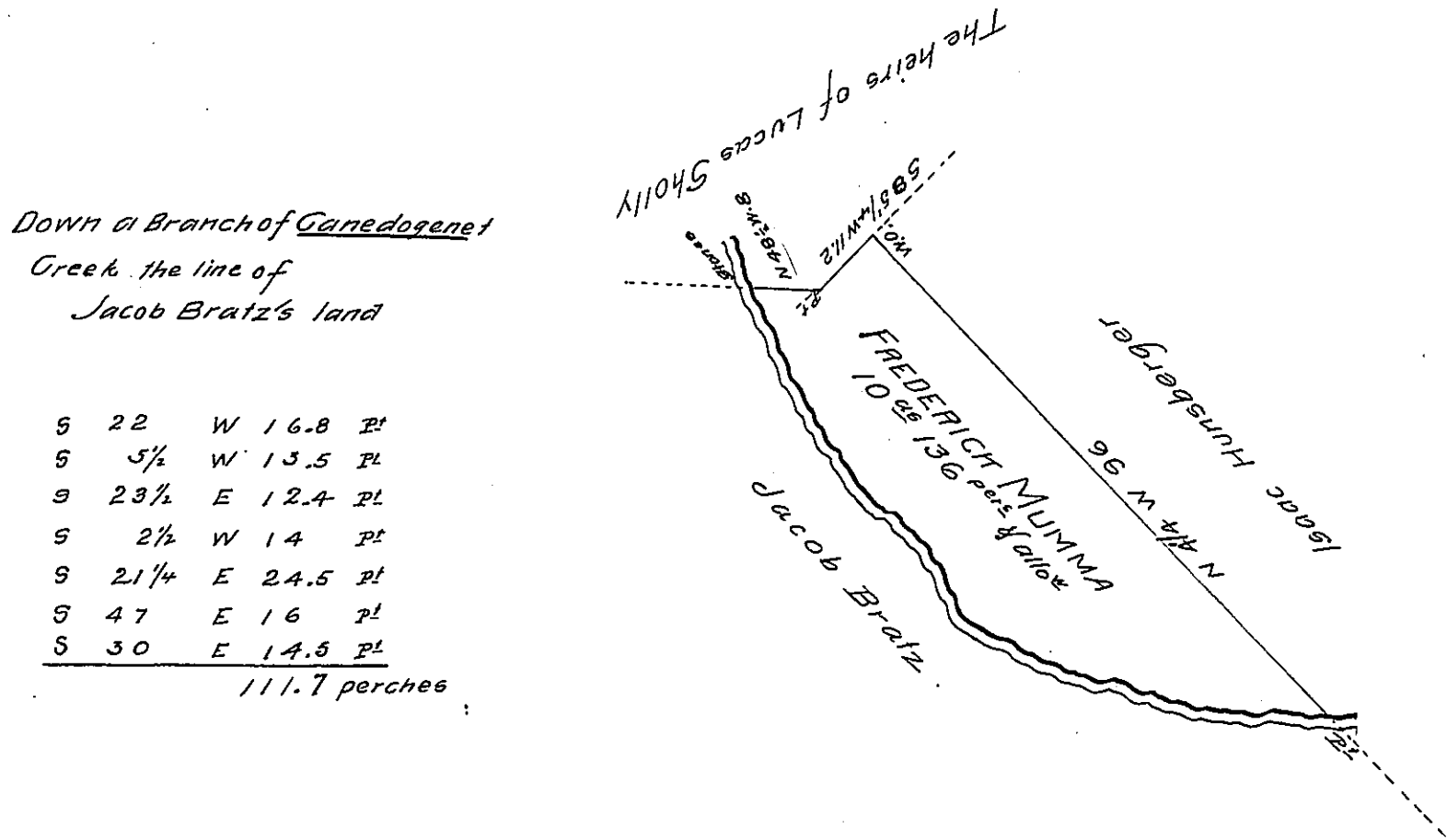

A Draught of a Tract of Land situate in Eastpennsborough township Cumberland County Containing 10^{as} 136 perches and the usual allowance of six per Cent for roads &c. Surveyed September the 20th 1814 in pursuance of a warrant granted to Frederick Mumma for 12^{as} bearing date the 24th day of June A. Domini 1814 - There was a family actually residing on said land at the time of making survey

W^m Line D.S.

To Rich^d T Leech Esq^t
Surveyor General Pa

N.B. The improvement on said land was made prior to the 28th day of February 1814. There was a warrant granted to Thomas Bosert for the above Land dated August 29th 1814

W^m Line D.S.

To Rich^d T Leech Esq^t S.G. Pa.

IN TESTIMONY that the above is a copy of the original remaining on file in the Department of Internal Affairs of Pennsylvania, made conformably to an Act of Assembly approved the 16th day of February 1833, I have hereunto set my hand and caused the Seal of said Department to be affixed at Harrisburg, this seventeenth day of December 1907

Henry Howard
Secretary of Internal Affairs.